

HL CONNECTOR

Disconnectable Crimp style Wire-to-wire connectors

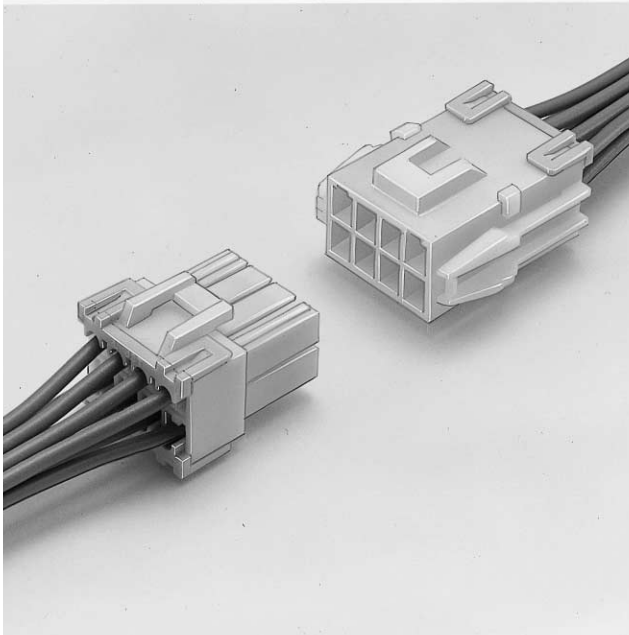

Features

• Low insertion force contact

The low insertion force contacts reduce surface finish wear and reduce the effects of stress relaxation.

• Housing lance

The resilient plastic housing lances secure the contacts in the housings. Since the lances are in the housings rather than on the contacts, they are not affected by handling, and allow the contacts to be lightly inserted without undue force. This establishes a feeling of uniform insertion and a noticeable change in that feeling when insertion is completed.

• Inner-housing lock

This inner-housing lock secures the plug to the receptacle and prevents accidental disconnection. The lock is protected and is not affected by external forces that might result from the routing of wires.

• Secondary retainers

The secondary retainers enhance safety in case of partial insertion or accidental release of the contact. Even if a contact is inserted incompletely, the retainer guides the contact to the proper position and securely locks it in place.

• Panel lock construction

Our unique compact panel lock is designed to prevent tangling with wires and accidental breakage because of handling.

Specifications

- Current rating: 7A AC, DC max.
- Voltage rating: 300V AC, DC max.
- Temperature range: -25°C to +90°C
(including temperature rise in applying electrical current)
- Contact resistance: Initial value/7m Ω max.
After environmental testing/10m Ω max.
- Insulation resistance: 1,000M Ω min.
- Withstanding voltage: 1,500V AC/minute
- Applicable wire: AWG #22 to #18
0.3 to 0.75mm²

• Applicable panel thickness: 0.7 to 2.0mm (.028" to .079")

* Contact JST if Lead-Free product is required.

* Temperature Range:

The aforementioned temperature range of this connector is described in JST Standard Product Specification.

Maximum temperature registered in UL is 105°C.

* Refer to "General Instruction and Notice when using Terminals and Connectors" at the end of this catalog.

* Contact JST for details.

Note: The current rating varies depending on the number of circuits and the wire size used in each connector. The table below lists the current rating as a function of the number of circuits and wire size.

Current unit: A

Circuits	Wire size (AWG)		
	#18	#20	#22
2	7	5	4
3	6	4	4
4	6	4	4
8	4	3	3
9	4	3	3
12	3	2	2

Standards

Recognized E60389 Certified LR20812 R9551072

802 **JST**

HL CONNECTOR

Contact



Model No.		Applicable wire			Q'ty / reel
Pin contact	Socket contact	mm ²	AWG #	Insulation O.D. mm(in.)	
SSM-21T-P1.4	SSF-21T-P1.4	0.3 to 0.75	22 to 18	1.5 to 2.2 (.059 to .087)	6,000

Material and Finish	
Phosphor bronze, tin-plated	

Note: Contact JST for special products.

Contact position location numbers

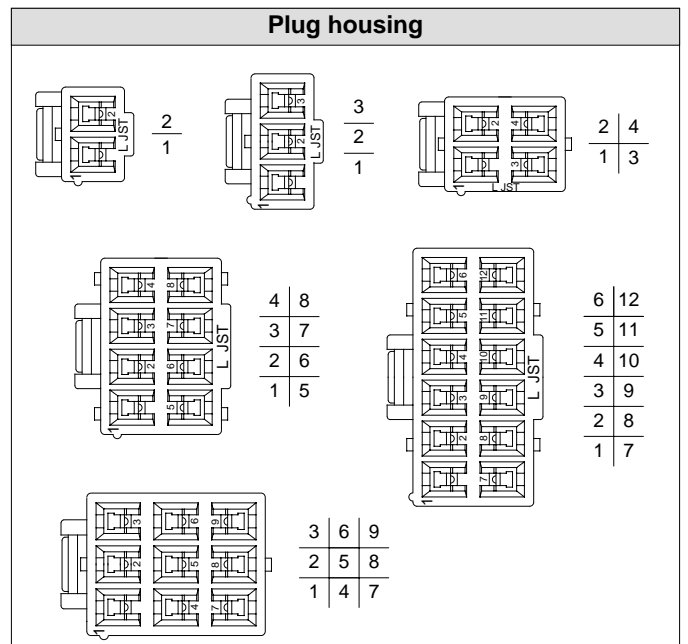
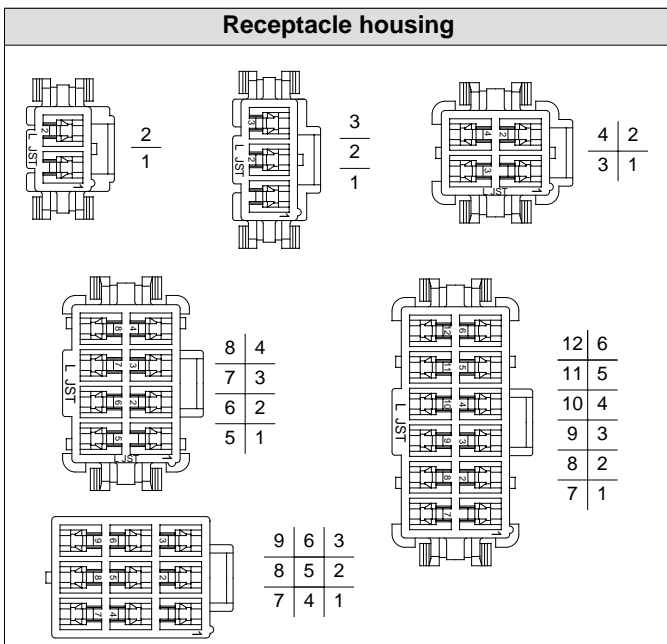
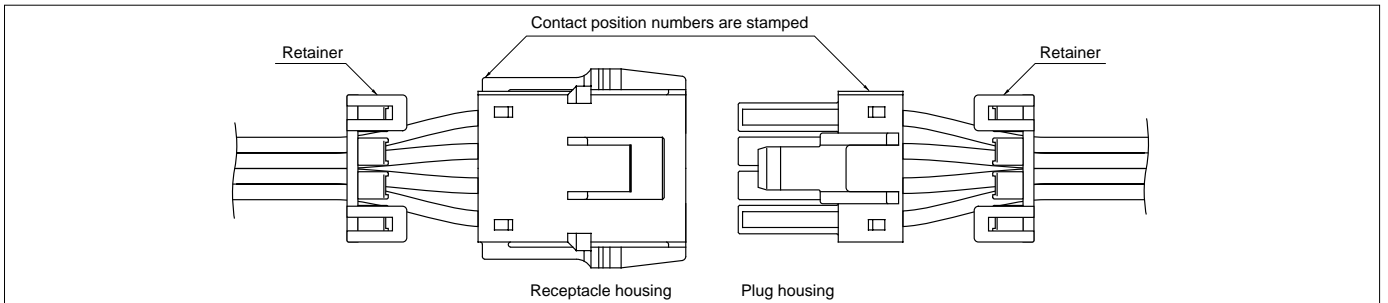

HL CONNECTOR

Housing

Material: Housing...Nylon 66, UL94V-0, white
Retainer...Glass-filled nylon 66, UL94V-0, ivory

Circuits	Voltage rating	Current rating	Receptacle housing(for pin contact)	Q'ty / bag	Plug housing(for socket contact)	Q'ty / bag	Retainer	Q'ty / bag
2	300V	7A	HLR-02V 	1,000	HLP-02V 	1,000	HLS-02V (commonly used for 2-circuit housing and 4-circuit housing) 	1,000
			HLR-02VF 					
3	300V	6A	HLR-03V 	500	HLP-03V 	1,000	HLS-03V 	1,000
			HLR-03VF 					
4	300V	6A	HLR-04V 	500	HLP-04V 	500	HLS-02V (commonly used for 2-circuit housing and 4-circuit housing) 	1,000
			HLR-04VF 					
8	300V	4A	HLR-08V 	500	HLP-08V 	500	HLS-08V 	1,000
			HLR-08VF 					
9	300V	4A	HLR-09VF 	500	HLP-09V 	500	-	-
			HLR-09V 					
12	300V	3A	HLR-12V 	500	HLP-12V 	500	HLS-12V 	1,000
			HLR-12VF 					

Panel layout

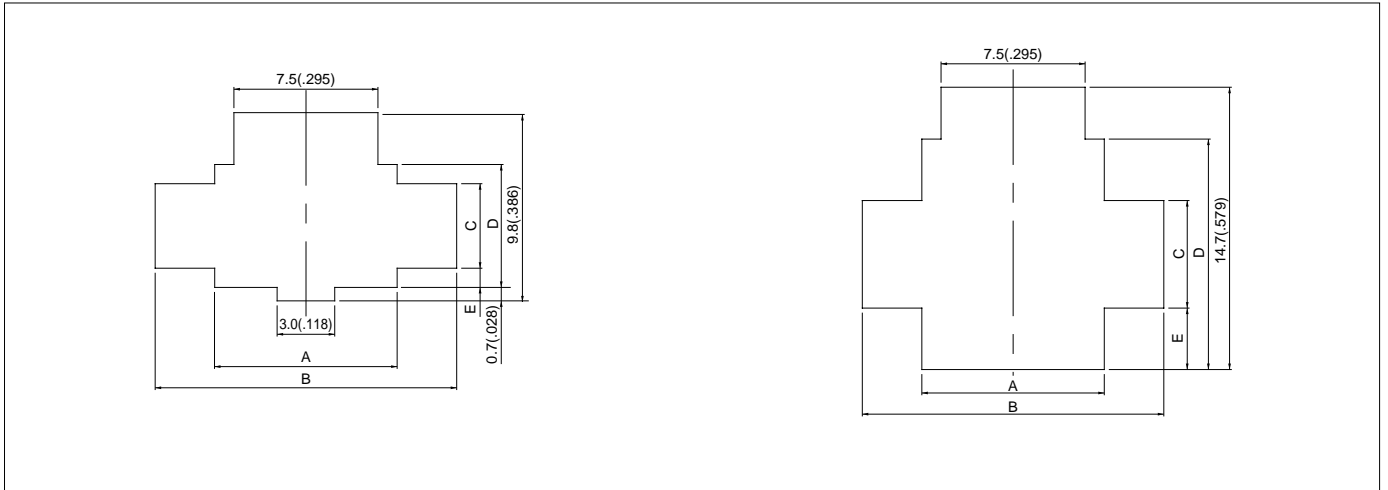

Circuits	Receptacle housing	Panel hole shape	Panel hole dimensions mm(in.)					Applicable panel thickness mm(in.)
			A ± 0.13 (.005)	B ± 0.13 (.005)	C ± 0.1 (.004)	D ± 0.13 (.005)	E ± 0.1 (.004)	
2	HLR-02V	I	9.5(.374)	15.7(.618)	4.4(.173)	6.4(.252)	1.0(.039)	0.7 to 2.0 (.028 to .079)
3	HLR-03V	I	13.5(.531)	19.7(.776)	4.4(.173)	6.4(.252)	1.0(.039)	
4	HLR-04V	II	9.5(.374)	15.7(.618)	5.6(.220)	12.0(.472)	3.2(.126)	
8	HLR-08V	II	17.4(.685)	23.6(.929)	5.6(.220)	12.0(.472)	3.2(.126)	
12	HLR-12V	II	25.3(.996)	31.6(1.244)	5.6(.220)	12.0(.472)	3.2(.126)	

Note:

1. Punch holes in the panel according to the sketch and table shown above. Burrs must be removed.
2. The strength of the panel must be considered when punching two or more holes.
3. The connector must be inserted from the same side as the hole is punched.

Assembly layout

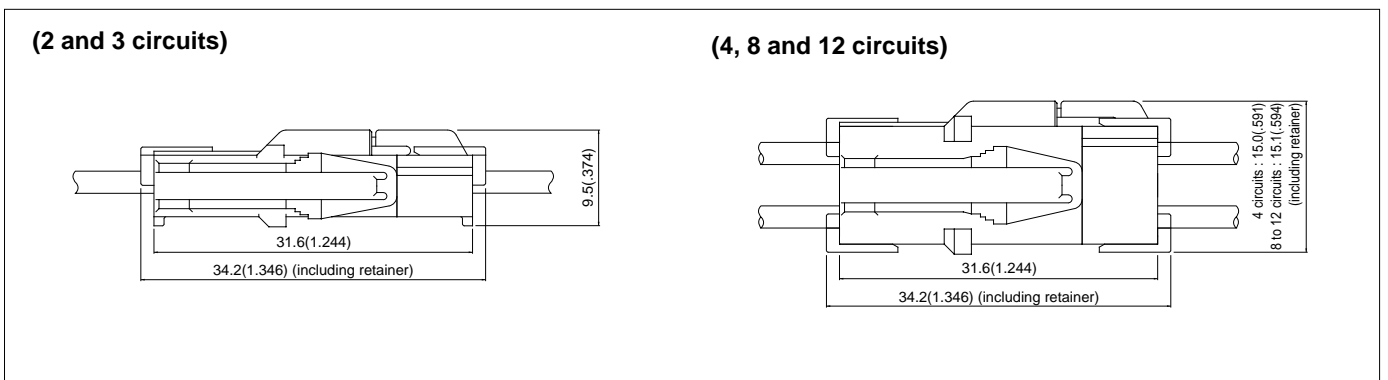

Applicator for the semi-automatic press AP-K2N

Contact	Crimp applicator MKS-L		Compact crimp applicator MKS-LS		Strip-crimp applicator MKS-SC
	with safety cover	without safety cover	with safety cover	without safety cover	with safety cover
SSF-21T-P1.4	APLMK SSF/M21-14	APLNC SSF/M21-14	-	-	-
SSM-21T-P1.4	APLMK SSF/M21-14	APLNC SSF/M21-14	-	-	-